

SILENCIADOR SPS

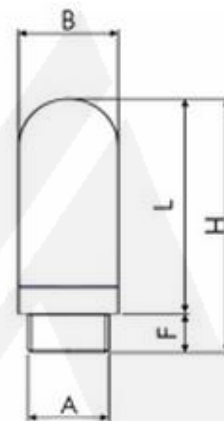

A	B	F	L	H	gr.
1/8"	13	6	22	28	2.8
1/4"	17	7	27	34	3.7
3/8"	25	10	54	64	10
1/2"	25	10	55	65	13.5
3/4"	37	15	122	137	37
1"	48	19	133	152	63.5
M5	7	4	20	24	0.2



Flow chart

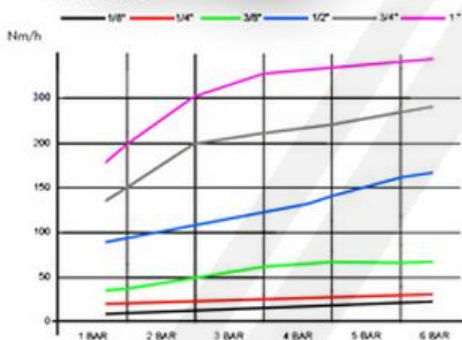

Acoustic fading

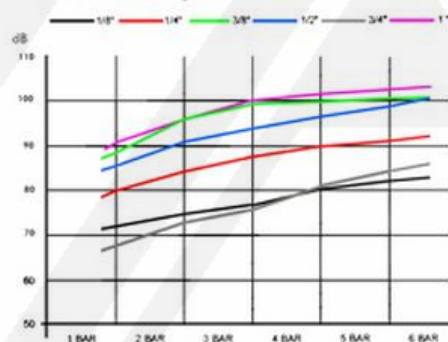

Main Features

Body : Nylon
 Silencer : Polyethylene
 Max Pressure : 6 B^{ar}
 Max Temperature : 80° C